

» WICLINE 95  
Turn /Turn-tilt/ Tilt/  
Tilt-first windows,  
passive house certified

WICLINE 95 meets the high requirements of the Dr. Feist Passive House Institute in Darmstadt, Germany, and due to its intelligent modular design offers maximum flexibility in planning projects.

In the WICLINE 95 the thermoframe insulator sits inside the window and can be finished as a sash-frame and conveniently installed by the installer using the intelligent Clips Technology. This allows a variable setting of the U<sub>f</sub> value of the window.

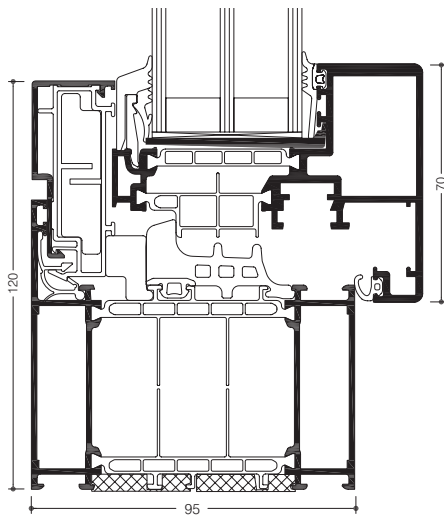

**System tests / CE-marked product passport according to DIN EN 14351-1:2006+A1:2010**

Air permeability:	Class 4
Waterproofing against driving rain :	E900
Resistance to wind load:	Class C5/B5
Soundproofing:	$R_w (C;C_v) = 47 (-1;-4) \text{ dB}$
Operating forces:	Class 1
Load capacity of safety precautions:	Fulfilled
Mechanical strength:	Class 4
Continuous operation:	Class 3 (20 000 cycles)
Corrosion resistance of fittings:	Class 5
Burglar resistance:	RC1N, RC2N, RC2, RC3
Quality management:	Certified to DIN EN ISO 9001:2008

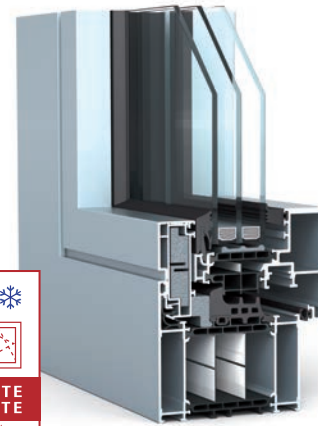
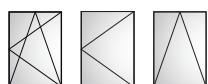

**Technical capabilities:**

**Profile technology:**

- Highly thermally insulated multi-chamber system with ETC Intelligence® thermal break 'zone', passive house certified to efficiency class phB.
- Patented corner and butt joint technology for high rigidity of components
- Infill thicknesses up to 55 mm

**Thermal insulation:**

- U<sub>f</sub> values 0.68 to 0.91 W/(m<sup>2</sup>K) for fixed glazed units with external sight lines from 65 to 180 mm
- U<sub>f</sub> values 0.75 to 0.88 W/(m<sup>2</sup>K) for sash-frame combinations with external sight lines from 105 to 260 mm
- Passive house efficiency class phB, U<sub>w</sub> and U<sub>f</sub> = 0.80 W/(m<sup>2</sup>K) with sight lines of only 125 mm and 95 mm sash-frame installation depth

**Sealing concept:**

- Large volume central seal in three variants:
  - Circumference installation without corner butts
  - With formed corners, no adhesive processing of butts
  - Corner vulcanised frames

**Hardware:**

- Concealed single handed operated fittings, optionally with:
  - overlaid hinges, coated or anodized in all colours
  - concealed hinges with integrated end position damping, opening angle max. 105°
- Sash weights:
  - concealed hinges: up to 160 kg
  - Visible hinges: up to 160 kg
- Sash sizes (w x h): up to 1300 mm x 2250 mm,
- Optionally with opening limiter

**System combinations:**

- Fully integratable into WICTEC façades using integration sash frames.